

**NOTES:**

- 1. AREAS MARKED AS \* INDICATE INACCESSIBLE AT TIME OF SURVEY



SMITH STREET

MACQUARIE STREET

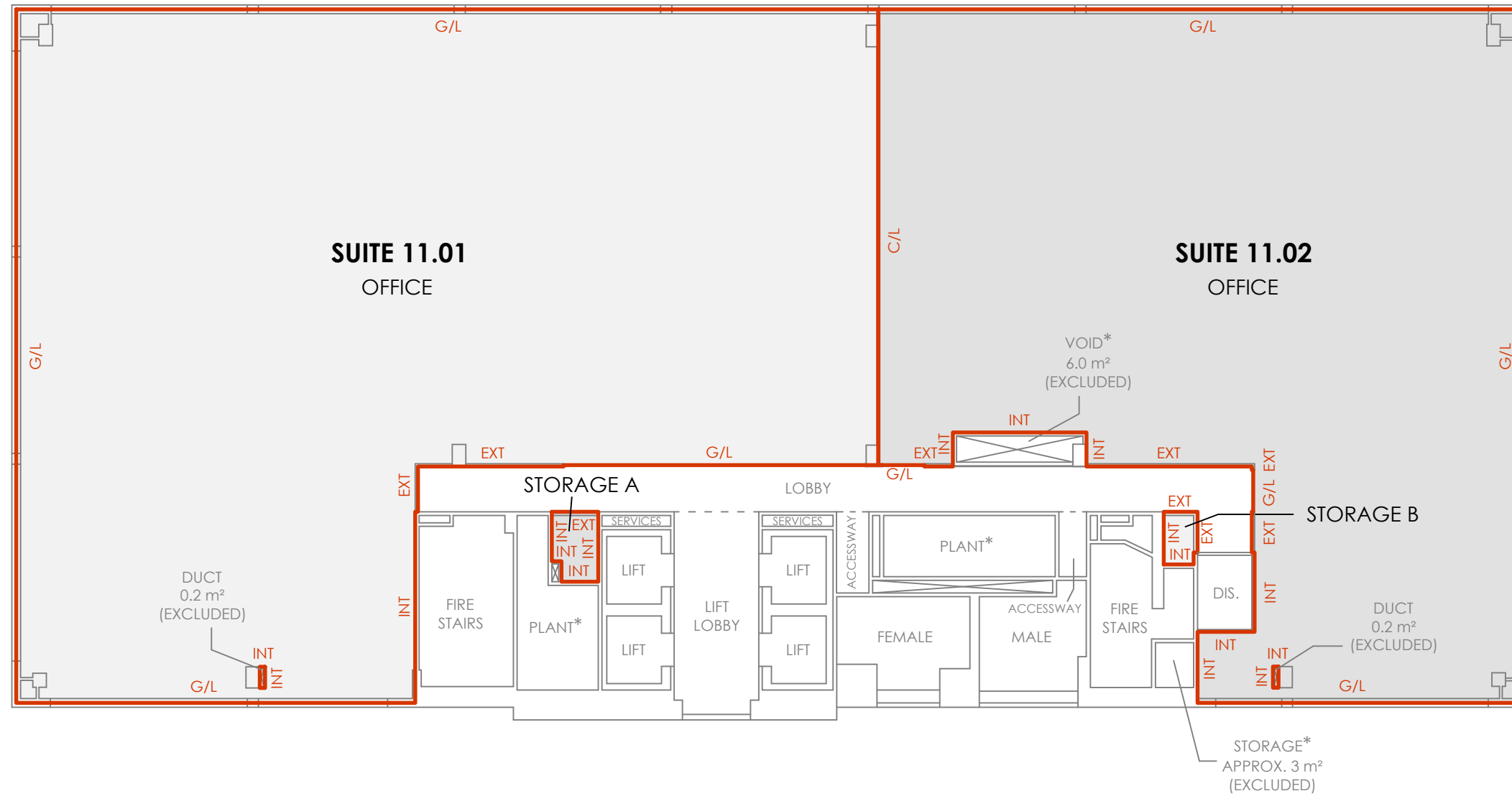

**SCHEDULE OF AREAS**

LEVEL 11	
SUITE 11.01	661.4 m <sup>2</sup>
SUITE 11.02	484.5 m <sup>2</sup>
STORAGE A	4.1 m <sup>2</sup>
STORAGE B	2.4 m <sup>2</sup>
<b>TOTAL AREA</b>	<b>1,152.4 m<sup>2</sup></b>

**LETTABLE AREA**



THE LETTABLE AREA IS SHOWN ENCLOSED BY CONTINUOUS LINES

**METHOD OF MEASUREMENT**

AREAS HAVE BEEN CALCULATED IN ACCORDANCE AND UNDER INTERPRETATION OF THE PROPERTY COUNCIL OF AUSTRALIA (PCA) METHOD OF MEASUREMENT FOR LETTABLE AREA (MARCH 1997)

(SURVEY DATE 03/02/2022)

**GUIDELINES USED  
NET LETTABLE AREA**

ALL PARTIES USING THE AREAS EXPRESSED HEREIN, SHOULD AGREE WITH THE BOUNDARY DEFINITIONS, THIS PLAN WAS PRODUCED FOR THE CALCULATION OF FLOOR AREAS ONLY

**LEGEND**

- INT - INTERNAL FACE
- EXT - EXTERNAL FACE
- C/L - CENTRELINE WALL
- G/L - GLASS LINE

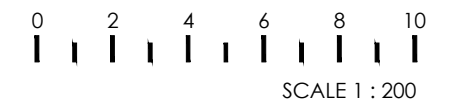

CLIENT:

**CBRE**

**LETTABLE AREA PLAN**

SUITES 11.01 & 11.02, LEVEL 11,  
10 SMITH STREET, PARRAMATTA, NSW

DATE: 11/02/2022

REF: 81400 REV: A  
DRAWN: AH CHECKED: CL  
SCALE: 1:200 @ A3 SHEET: 1 OF 1

Australia | New Zealand

**REALSERVE**

Start confident.

Building Measurement Specialist

Consulting Land Surveyors

3D Laser Scanning

ph. 02 9629 9377

www.realserve.com.au